



Verladetechnik Industrietore

Ronnenberger Straße 20  
30989 Gehrden  
phone +49 (0) 5108 879 270  
www.promstahl.de

## Product datasheet

Wheel guides  
(flanged version / to be fixed in concrete)

Version: 1.2.0

Date: 13.02.2023

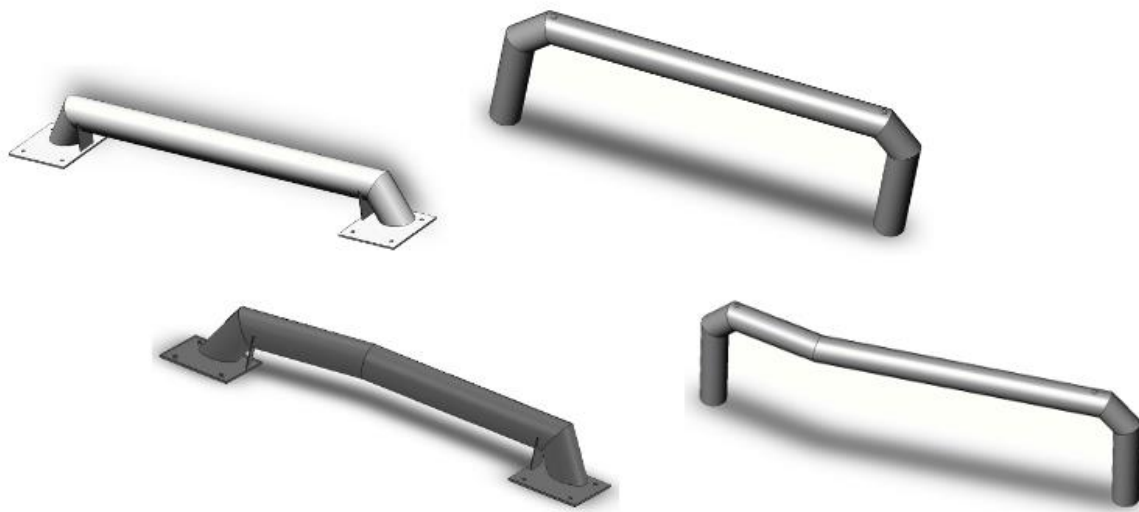

## Product datasheet

Wheel guides  
(flanged version / to be fixed in concrete)  
Type: PEF/ PEFE/ PEK/ PEKE/ SMART PEF

### Contact:



Ronnenberger Straße 20  
D-30989 Gehrden

phone +49 (0) 5108 879 270  
fax +49 (0) 5108 879 2710

info@promstahl.de  
www.promstahl.de

# Wheel guides

PROMStahl wheel guides guarantee precise dock-in at the loading bay and avoid expensive damage to dock shelters, levellers, buildings and to the vehicles caused by imprecise docking processes. Thanks to the wheel guides' smooth surface the vehicles' tires and wheel rims are not subject to any damage.

The wheel guides help the truck driver to reverse to the loading bay without requiring any complicated manoeuvring actions. They are installed on yard level, either by being fixed in concrete (types PEK and PEKE) or by being bolted into the ground (flanged version, type PEF and PEKE) and represent a good and reasonable investment in the safety at your loading bay.

There are 6 different versions of wheel guides:

## Flanged version

- **PEFE (ECO)**  
NL = 2000 mm (straight version)
- **PEF**  
NL = 2000 (angled version)
- **SMART PEF**  
NL = 2500 (angled version)
- **PEF**  
NL = 2550 (angled version)

## To be fixed in concrete

- **PEKE (ECO)**  
NL= 2000 mm (straight version)
- **PEK**  
NL = 2550 mm (angled version)

PROMStahl wheel guides consist of robust steel tubes (Ø159 mm) which are fixed to the ground at a distance of 2500 mm in front of the loading / unloading opening of the building. We recommend a distance of at least 2400 mm between the two wheel guides.

All PROMStahl wheel guides are available as angled or straight versions; they are hot-dip galvanized and can also be delivered in different RAL colours.

## PEF version (flanged version)

<b>PEFE 2000</b> (straight design)			
Nominal length	2000 mm		
Height (after installation)	245 mm		
Tube diameter	159 mm		
Tube thickness	4 mm		
Flange dimensions	335 x 335 x 10 mm		
		<b>PEF 2000</b> (angled design)	
		Nominal length	2000 mm
		Height (after installation)	245 mm
		Tube diameter	159 mm
		Tube thickness	4 mm
		Flange dimensions	335 x 335 x 10 mm
<b>PEF 2550</b> (angled design)			
Nominal length	2550 mm		
Height (after installation)	245 mm		
Tube diameter	159 mm		
Tube thickness	4 mm		
Flange dimensions	335 x 335 x 10 mm		
		<b>SMART PEF</b> (angled design)	
		Nominal length	2500 mm
		Height (after installation)	215 mm
		Tube diameter	159 mm
		Tube thickness	4 mm

## PEK version (set in concrete)

<b>PEKE 2000</b> (straight design)			
Nominal length	2000 mm		
Height (after fixing in concrete)	245 mm		
Tube diameter	159 mm		
Tube thickness	4 mm		
		<b>PEK 2550</b> (angled design)	
		Nominal length	2550 mm
		Height (after setting in concrete)	245 mm
		Tube diameter	159 mm
		Tube thickness	4 mm