

Product datasheet

Curtain-type dock shelter with parallel guide system

Type: PMVS2

Contact:

Ronnenberger Straße 20
D-30989 Gehrdenphone +49 (0) 5108 879 270
fax +49 (0) 5108 879 2710info@promstahl.de
www.promstahl.de

Mechanical dock shelter type PMVS2

The mechanical dock shelter PMVS2 is a new product of PROMStahl's wide product range. Various dimensions of warehouse openings and of the docked vehicles result in gaps which have to be sealed in the best possible way.

The front and rear frame of the PROMStahl dock shelter consist of high-strength, weather-resistant steel profiles that are connected to each other by articulated arms. The use of anodised aluminium keder profiles is an excellent choice for fixing the curtains as they are ideal for outdoor use due to their resistance to corrosion. They can withstand various weather conditions and are therefore a durable and reliable option for mechanical dock shelters.

The curtain is 3 mm thick, made of highly wear and tear resistant double-layer PVC-coated cloth and mounted on the flexible frame. Thanks to the adaptable roof and the parallel guide systems the front structure moves backward in the case of inaccurate docking, hence preventing damage to the dock shelter. The front part of the dock shelter is provided with warning stripes to facilitate the docking process. The special roof design and the eaves edge ensure that rainwater is drained off to the side in a controlled manner.

The standard version of the dock shelter is provided with a slit in the left and right-hand corner. Partially or completely slit top curtains are available at little surcharge. The PMVS2 dock shelter is pre-mounted and consists of just three parts; therefore, it can be mounted to the façade very fast and easily. Considerable savings regarding time and money are the decisive advantages of this design.

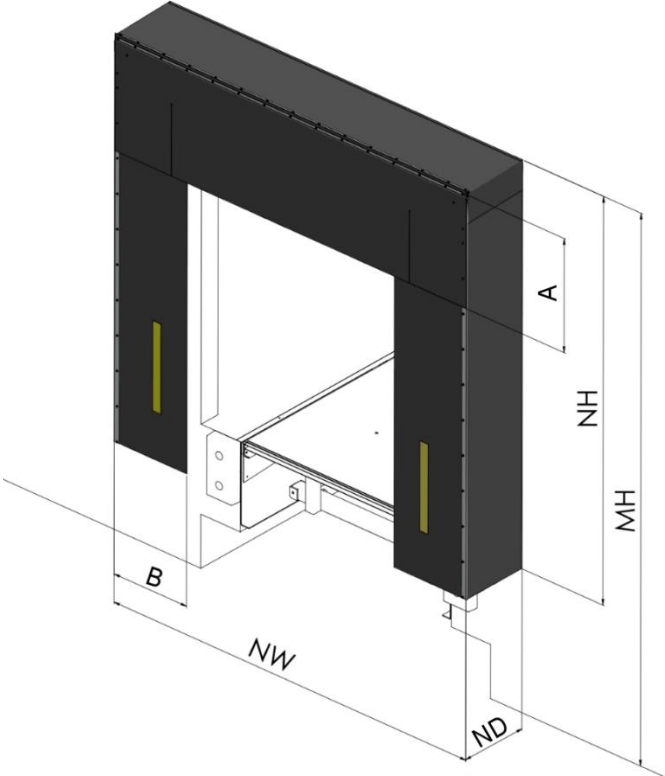

- NW Nominal width
- NH Nominal height
- ND Nominal depth
- MH Installation height (recommendation 4600 mm)
- A Top curtain height
- B Side curtain width

Standard parameters

Nominal width of the dock shelter (NW):	3250 mm, 3300 mm, 3400 mm, 3450 mm 3500 mm, 3550 mm
Nominal height of the dock shelter (NH):	3200 mm, 3400 mm, 3500 mm, 3600 mm 4000 mm, 4600 mm
Nominal depth of the dock shelter (ND):	600 mm
Height of the top curtain (A):	1000 mm
Width of the side curtain (B):	600 mm (up to NW 3300 mm) 700 mm (from NW 3400 mm)

Options

Nominal width of the dock shelter (NW):	Further sizes on request.
Nominal height of the dock shelter (NH):	Further sizes on request.
Nominal depth of the dock shelter (ND):	900 mm
Height of the top curtain (A):	1200 mm, 1500 mm
Others:	Partly slit top curtain Completely slit top curtain Sealing devices Number on the top curtain Yellow warning stripes Wind protection set: reinforcement lamellas for the side curtains and top curtain protection (only possible for standard version top curtains) Cut-outs in the side curtains Electrical blind

Curtain specification

Top curtain and side curtain characteristics:

- double-layer PVC-coated polyester cloth
- total weight: about 3800 g/m² in accordance with the EN ISO 2286-2 standard
- material thickness: 3 mm
- temperature stability: - 25° C/ +70° C
- low flammability in accordance with the DIN 75200 standard
- tensile strength / maximum tensile force in accordance with DIN EN ISO 1421/V1
 - longitudinal tensile strength: about 6000 N/ 50 mm
 - transverse tensile strength: about 5000 N/ 50 mm
- tear propagation strength in accordance with DIN 53363
 - longitudinal tear propagation strength: about 1000 N
 - transverse tear propagation strength: about 900 N

Continuous curtain characteristics:

- single-layer PVC-coated polyester cloth
- total weight: about 600 g/m² in accordance with EN ISO 2286-2
- material thickness: 0,5 mm
- temperature stability: - 40° C/ +70° C
- low flammability in accordance with DIN 75200
- tensile strength / maximum tensile force in accordance with DIN EN ISO 1421/V1
 - longitudinal tensile strength: about 2000 N/ 50 mm
 - transverse tensile strength: about 2000 N/ 50 mm
- tear propagation strength in accordance with DIN 53363
 - longitudinal tear propagation strength: about 200 N
 - transverse tear propagation strength: about 150 N

Options

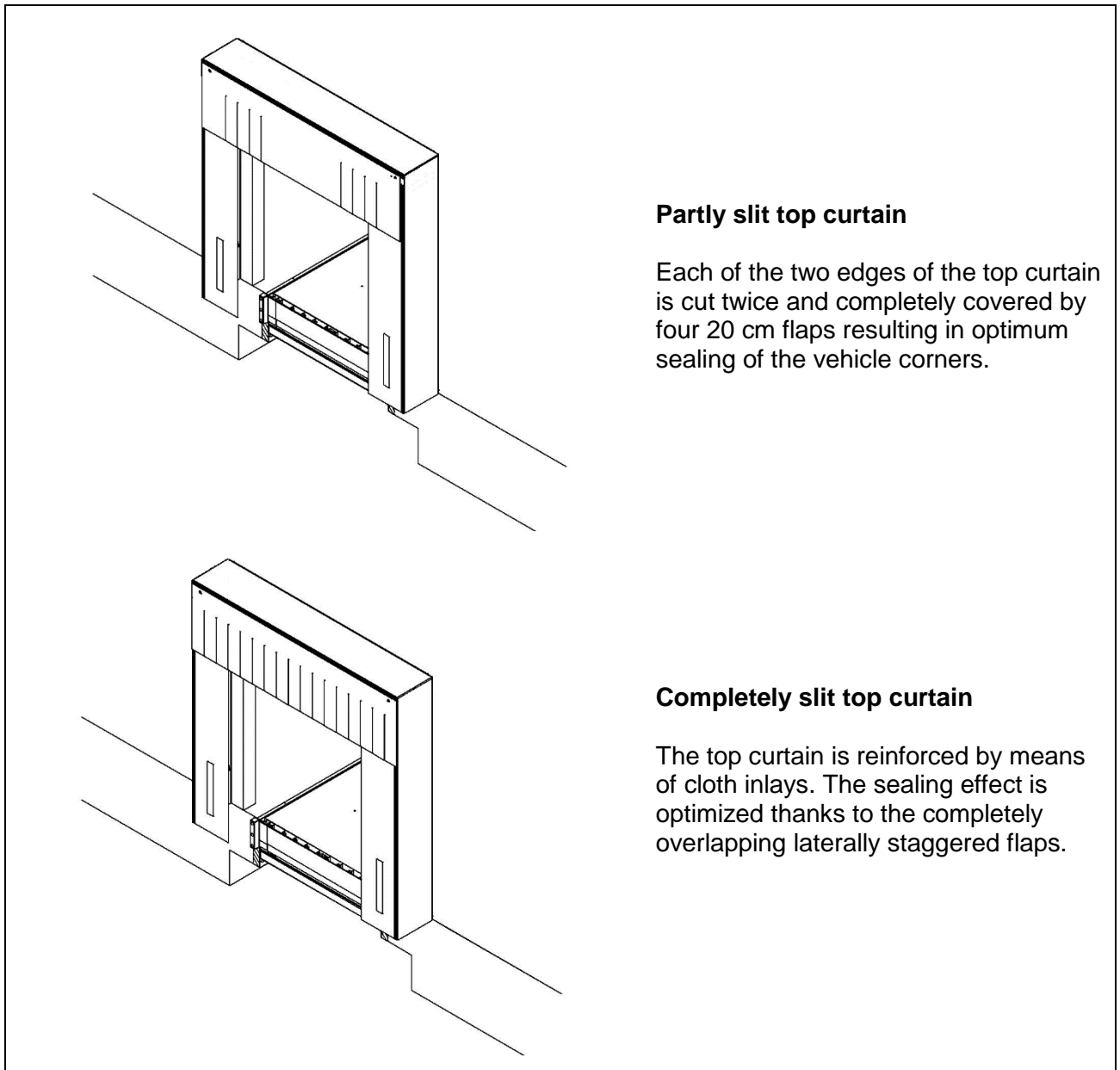

Partly slit top curtain

Each of the two edges of the top curtain is cut twice and completely covered by four 20 cm flaps resulting in optimum sealing of the vehicle corners.

Completely slit top curtain

The top curtain is reinforced by means of cloth inlays. The sealing effect is optimized thanks to the completely overlapping laterally staggered flaps.

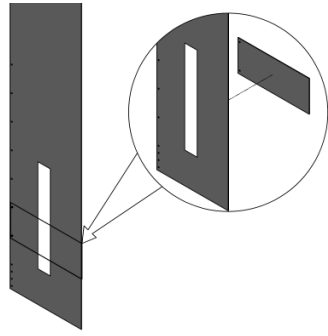

Wind protection set

Reinforcement lamellas

An additional reinforcement rubber lamella on each side ensures that the side curtain remains stable and does not fold over in strong winds or under other loads.

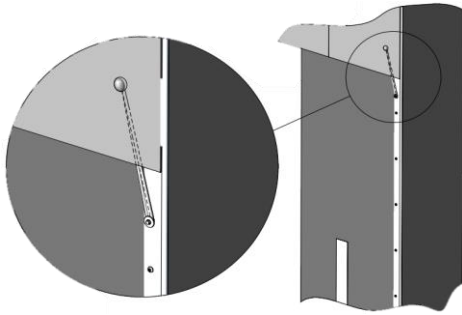

Wind protection of the top curtain

The additional securing of the top curtain with two elastic tensioning ropes offers effective protection against the top curtain folding over, especially under strong wind conditions (not suitable for partially or fully slit top curtains).



Side curtain

The recesses in the side curtains protect the dock shelter against damage when using buffers mounted above the ramp height.

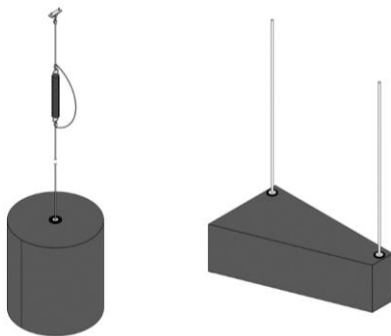

Sealing devices

The corner seals and bumpers are coated with high-resistant PVC material and guarantee perfect protection against draught during loading and unloading.

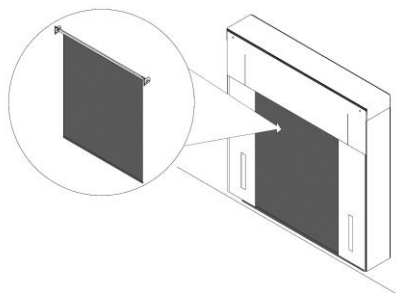

Electrical roller blind

The motorised roller blind is used to bridge height differences of the most diverse vehicle types.

It is operated directly via the roller blind control or optionally via a button on the leveller control unit.

Easy retrofitting is possible due to simple assembly

PMVS2 fixing

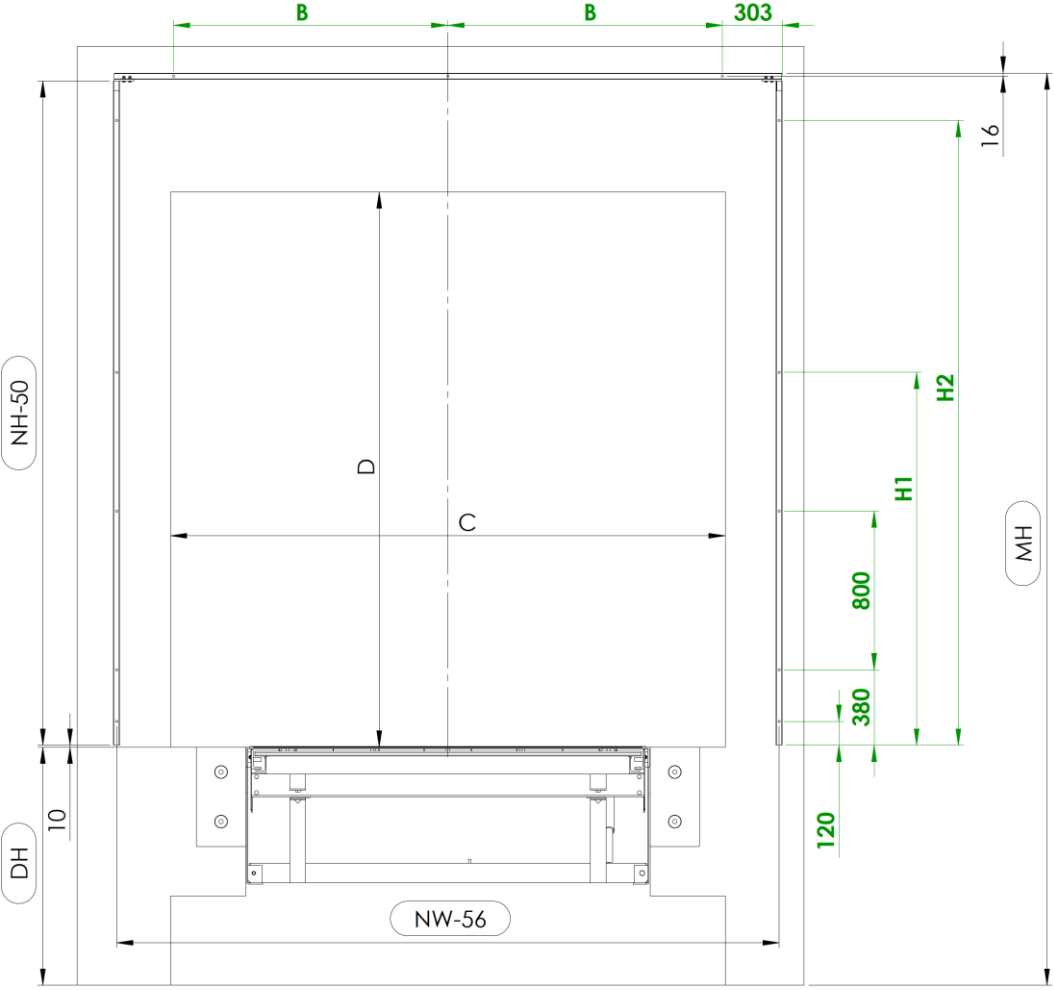

- NW Nominal width
- MH Installation height (Recommendation 4600 mm)
- C Door width
- NH Nominal height
- DH Dock height
- D Door height

NW [mm]	B [mm]
3200	1285
3250	1310
3300	1335
3350	1360
3400	1385
3450	1410
3500	1435
3550	1460
3600	1485

NH [mm]	H1 [mm]	H2 [mm]
3200	1680	2950
3300	1780	3050
3400	1880	3150
3500	1980	3250
3600	2080	3350
3700	2180	3450
3800	2280	3550
3900	2380	3650
4000	2480	3750
4100	2580	3850
4200	2680	3950
4300	2780	4050
4400	2880	4150
4500	2980	4250
4600	3080	4350
4700	3180	4450

Wall fixing

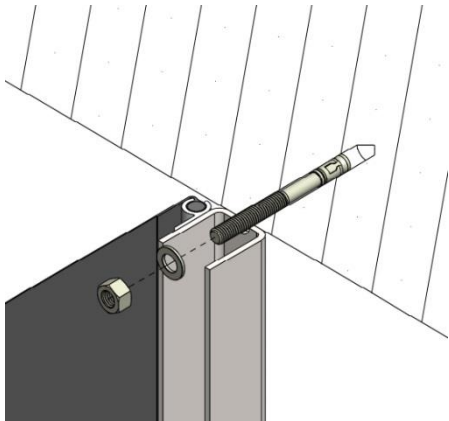

Concrete (heavy duty)

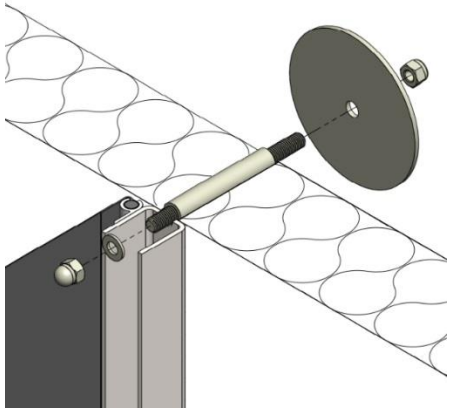

ISO material
(wall thickness 60 mm, 80 mm, 100 mm)

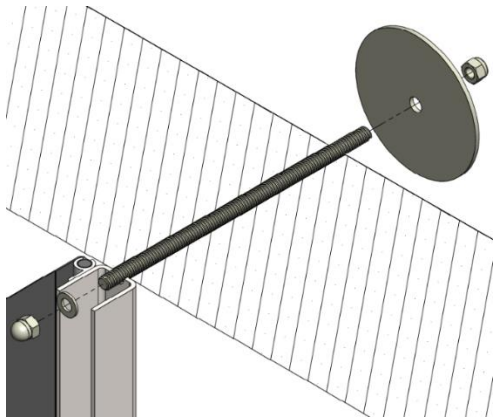

Aerated autoclaved concrete
(maximum wall thickness: 300 mm)

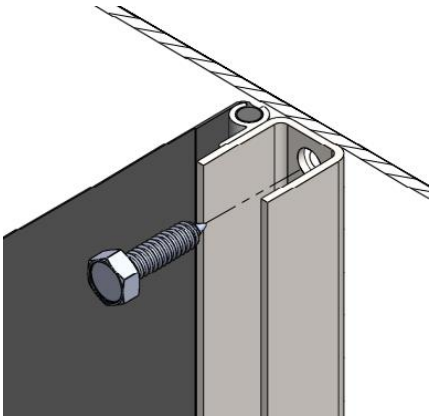

Plain sheet material
(plain sheet thickness ≥ 3 mm)

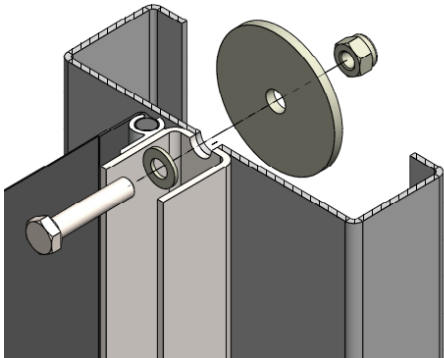

Plain sheet material
(plain sheet thickness < 3 mm)